A scenic view of a Parisian river, likely the Seine, with a white boat docked on the left. In the background, there are several large, modern buildings and the Eiffel Tower in the distance. The sky is blue with some light clouds.

## H2020: How does UPMC assess its participation so far?

Elena Billi-Rizza, *Head of European Affairs Office*

19/11/2015

[www.upmc.fr](http://www.upmc.fr)

**UPMC**  
SORBONNE UNIVERSITÉS

# UPMC: facts and figures



- University Pierre et Marie Curie has come to embody French excellence in science and medicine.
- The University is made up of seven Research and Training Units in Engineering, Mathematics, Chemistry, Physics, Earth and Environmental Sciences, Life, Biodiversity and Medicine.
- 32,000 students, of which 6,400 are international
- 10,500 in staff, of which 8,200 are in research structures
- 18 sites across 4 regions in France

# UPMC in Europe – Strategy

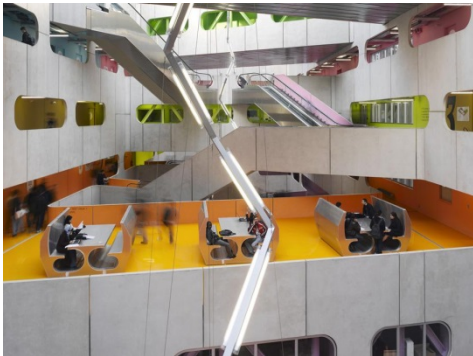

1. To building partnerships first and foremost in Europe (64 % of our institutional agreements).
2. To work to advance the ERA
3. To be involved in the definition and implementation of European policies in higher research and education.
4. To develop incentive mechanisms to promote the investment and participation to the European programs.
5. To actively participate in European projects for education and research.

# UPMC in Europe – Approach



This can be seen through our three-pronged approach:

1. European Networks: UPMC is a committed member of UNICA, LERU, EUA

2. Education Programs: UPMC is continuously developing a more dynamic European component to its degree programs, encouraging student exchanges within the European Union



3. Research Programs: UPMC's research strategy directly supports European priorities and UPMC is one of France's most active participants in EU-sponsored research projects.

# UPMC in Europe – Organisation



## 1. Politics and Strategy:

- Vice-Rector for International Relations,
- Vice- Rector for Europe and
- Vice- Rector for Research and Innovation

## 2. Support departments:

- Education Programs: DRI (international students mobility, hosting foreign faculty researchers, implementation of training projects, and supporting the establishment of international research cooperation projects.
- Research Programs: DGRTT

# DGRTT: Directorate-General for Research and Technology Transfert



About 80 people working on:

- European research programs
- Other national or international funds (public agencies, foundations, ...)
- Private contracts
- Technology transfer
- Intellectual property
- Human resources
- Financial affairs
- UPMC research affairs

# European Affairs Office

**15 people working on:**

- Coordinating and assessing UPMC participation to European research programmes
- Ensuring a strategic watch
- Participating to European and national networks, French Programme Committees and NCP
- Informing and helping researchers to find funds (including training)
- Providing assistance to researchers in the drafting of proposals, the negotiation and the financial, administrative and legal management of projects



# How to assess UPMC participation to H2020?

## « Quantity »



### 1. What numbers?

- Projects (submitted vs. funded) per year
  - « program » (ERC, MSC, IA, RIA, CSA, ..., pillar)
  - role (coordinator, partner, third party)
  - lab
  - employer (JRU)
  - success rate (program, role, ...)
- Budgets
  - per year and global
  - per lab

### 2. How?

- Data bases
  - External (participant portal, Ministry data-bases)
  - Internal (UPMC own data-bases)
- Rankings (ANRT, Ministry, ...)



# How do we assess UPMC H2020 participation ?

## « Quality »



1. Numbers: *same as « quantity »*

2. Sources:

- *same as « quantity »*
- Questions & Answers

3. For what?

- Who participates? And who does not?
- In which programs?
- **Why?**
- What UPMC should do to improve participation and/or success rate?
- To measure the Office activity

# UPMC in FP7

Success rate: 33%

JRU: about 1/3 of UPMC labs projects are obtained by CNRS + INSERM

	2007	2008	2009	2010	2011	2012	2013	Ensemble 7e PCRD
<b>NBRE DE PROJETS PRE-REPERES PAR L'OST (PERIMETRE OST)</b>	27	10	18	23	36	18	21	153
S-Coordinateur	5	2	6	7	9	6	6	41
S-Participant	22	8	12	16	27	12	15	112
<b>NBRE DE PROJETS REPERES PAR VOS SOINS (PERIMETRE ELARGI)</b>	52	20	25	32	45	30	22	226
S-Coordinateur	5	2	6	7	9	6	6	41
S-Participant	22	8	12	16	27	12	15	112
T-Clause 10	25	10	7	9	9	12	1	73
T-Sous-traitance	0	0	0	0	0	0	0	0
T-par MAD	0	0	0	0	0	0	0	0
T-Autre	0	0	0	0	0	0	0	0

# UPMC in H2020

Submitted (01/01/2014 – 31/10/2015)

JRU: about 1/4 of UPMC labs projects are obtained by CNRS + INSERM

ERC	MSC	RIA	IA	CSA	Others	TOT
65	96	110	6	15	2	308

Signed (01/01/2014 – 31/10/2015)

ERC	MSC	RIA	IA	CSA	Others	TOT
11	9	24	1	5	4	54

Success rate: 24,9% (on evaluated projects)

# UPMC in France

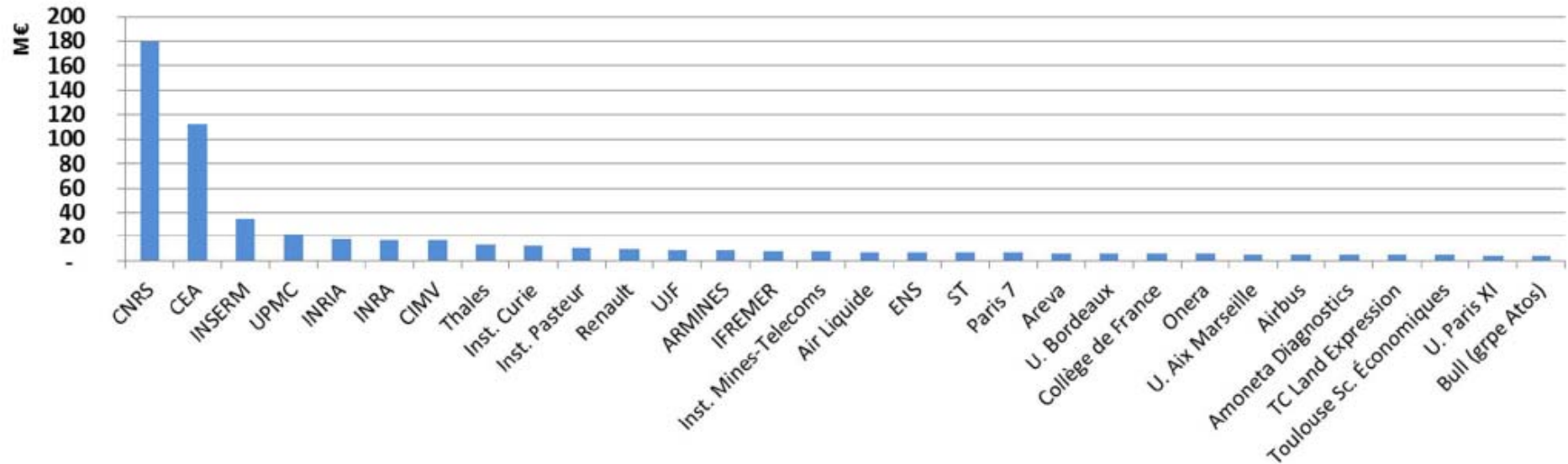

- Source: Research Ministry  
(Ranking of 50 first French actors in H2020, 01/01/2014 – 01/07/2015)

# UPMC in Europe

- Source: ANRT  
(Ranking of 60 first Universities funded in H2020, 01/01/2014 – 01/07/2015)

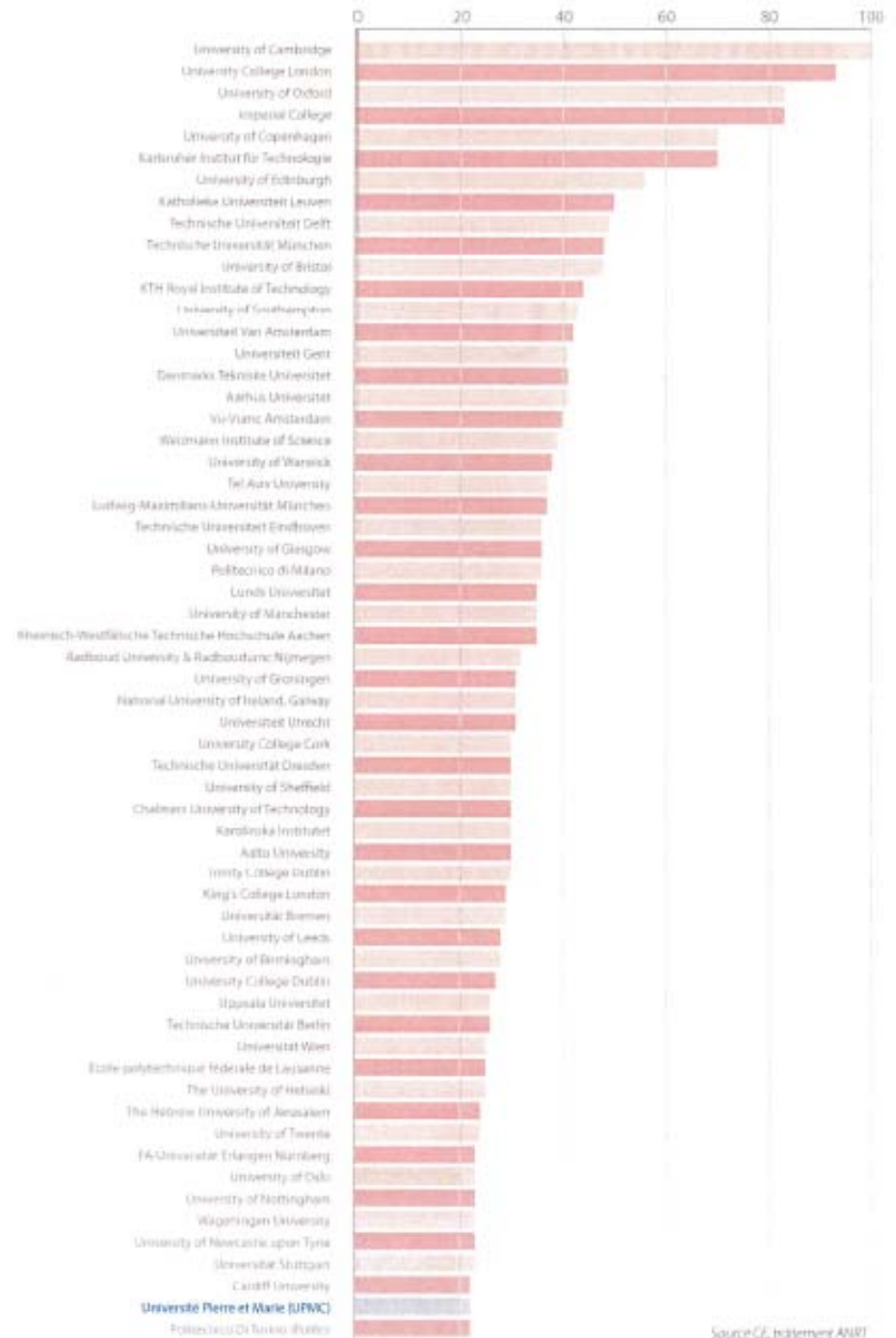



## 1. Increasing numbers FP7 – H2020:

- clear strategy, political support, improved organisation and investments (EU Affairs Office and linked services, 28 people)
- researchers experience in projects, high quality networks

## 2. Decreasing success rate:

- Increasing number of excellent actors
- Project funded “as it is”

## 3. Position in rankings

- UPMC is well positioned in France
- Benchmarking to strengthen UPMC position in the ERA

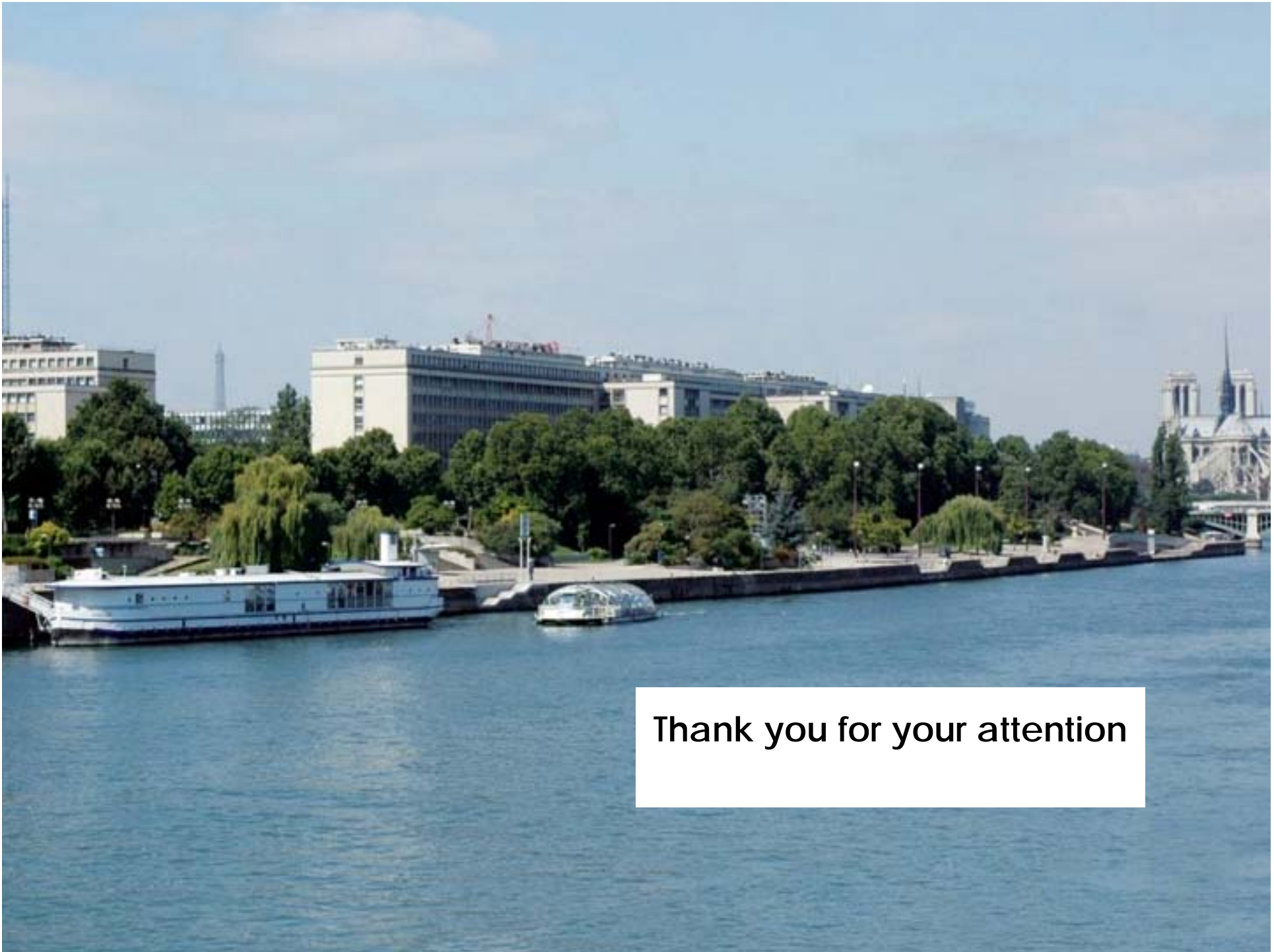

Thank you for your attention